

Nr. cadastral	Suprafata masurata, [mp]	Adresa imobilului
	59343	Mun. Baia Mare, bd. Unirii, jud. Maramures
Nr. Cartea Funciara		Unitatea Administrativ Teritoriala (UAT)
		BAIA MARE

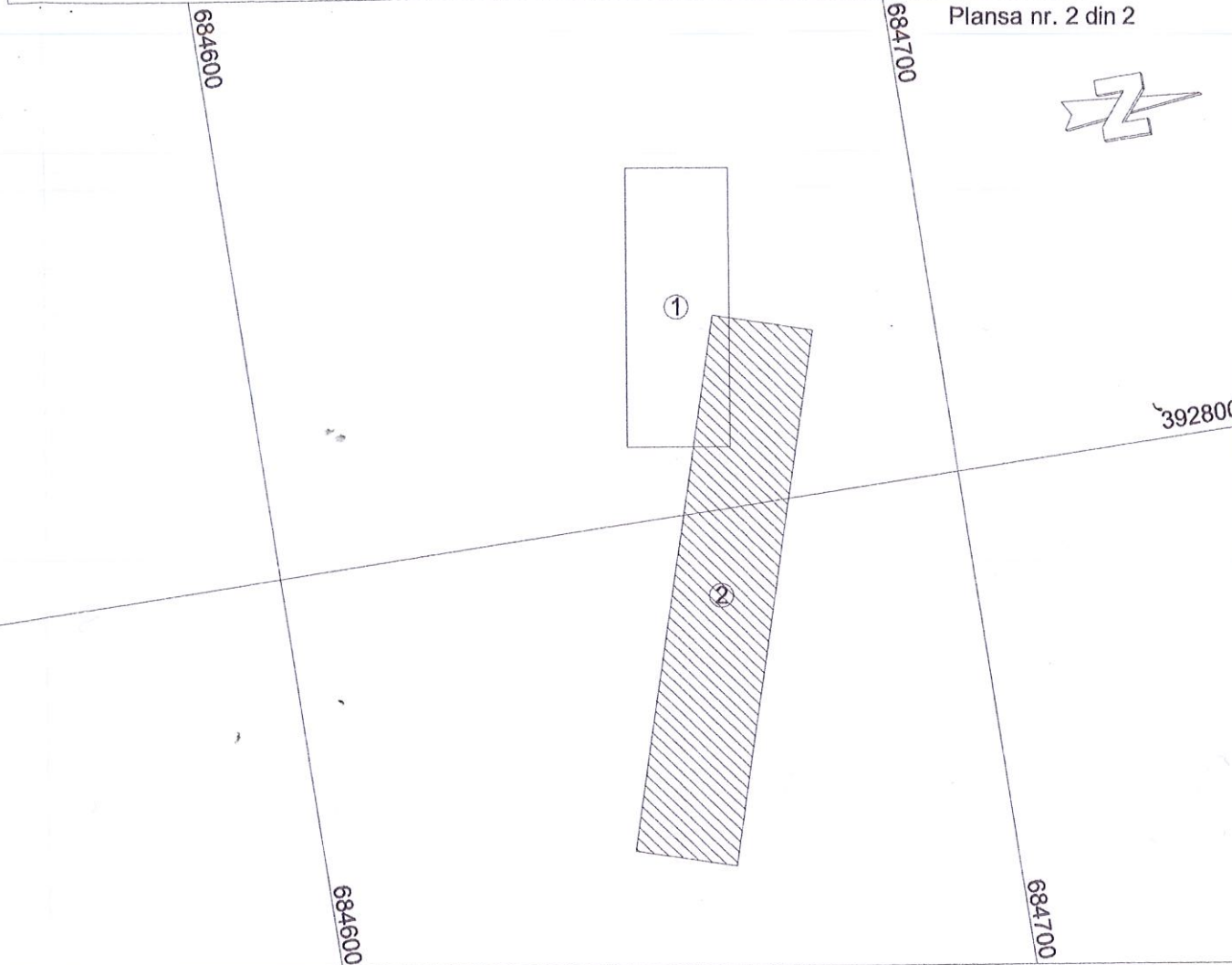

A. Date referitoare la teren			
Nr. parcela	Categorie de folosinta	Suprafata [mp]	Mentuni
1	DR	59343	Intravilan.
TOTAL		59343	Bulevardul Unirii, tronson 2.

B. Date referitoare la constructii			
Cod constructie	Destinatia	Supraf. constr. la sol, [mp]	Mentuni
-	-	-	-
TOTAL		-	-

Suprafata totala masurata a imobilului = 59343 mp
 Suprafata din act = 59343 mp

Executant: S.C. TOPO EXPERT S.R.L.
 Ing. Ardelean Vasile Alexandru

Inspector: _____

Confirm introducerea imobilului in baza de date integrata si atribuirea numarului cadastral

Semnatura si parafa

Stampila BCPI

Data: 27.03.2018

Data:

Seals: A.N.C.P.I., ARDELEAN VASILE-ALEXANDRU, S.C. TOPO EXPERT S.R.L., Categoria A

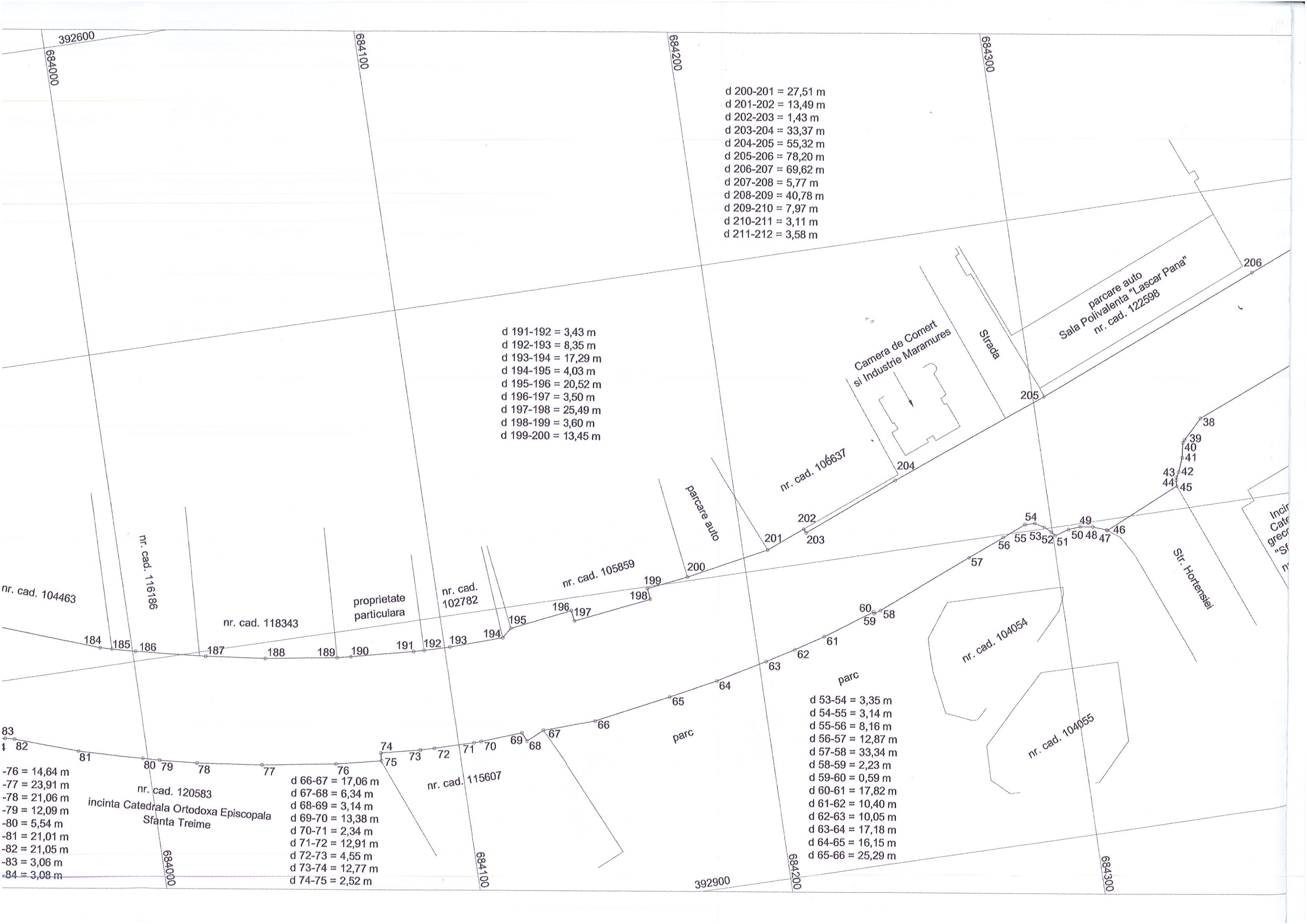

d 200-201 = 27,51 m
 d 201-202 = 13,49 m
 d 202-203 = 1,43 m
 d 203-204 = 33,37 m
 d 204-205 = 55,32 m
 d 205-206 = 78,20 m
 d 206-207 = 69,62 m
 d 207-208 = 5,77 m
 d 208-209 = 40,78 m
 d 209-210 = 7,97 m
 d 210-211 = 3,11 m
 d 211-212 = 3,58 m

d 191-192 = 3,43 m
 d 192-193 = 8,35 m
 d 193-194 = 17,29 m
 d 194-195 = 4,03 m
 d 195-196 = 20,52 m
 d 196-197 = 3,50 m
 d 197-198 = 25,49 m
 d 198-199 = 3,60 m
 d 199-200 = 13,45 m

Camera de Comert
si Industrie Maramures

parcare auto
 Sala Polivalenta "Lascar Pana"
 nr. cad. 122598

nr. cad. 104463

nr. cad. 116186

nr. cad. 118343

proprietate
particulara

nr. cad. 102782

nr. cad. 105859

nr. cad. 104054

nr. cad. 104055

-76 = 14,64 m
 -77 = 23,91 m
 -78 = 21,06 m
 -79 = 12,09 m
 -80 = 5,54 m
 -81 = 21,01 m
 -82 = 21,05 m
 -83 = 3,06 m
 -84 = 3,08 m

nr. cad. 120583
 incinta Catedrala Ortodoxa Episcopala
 Sfanta Treime

d 66-67 = 17,06 m
 d 67-68 = 6,34 m
 d 68-69 = 3,14 m
 d 69-70 = 13,38 m
 d 70-71 = 2,34 m
 d 71-72 = 12,91 m
 d 72-73 = 4,55 m
 d 73-74 = 12,77 m
 d 74-75 = 2,52 m

nr. cad. 115607

parc
 d 53-54 = 3,35 m
 d 54-55 = 3,14 m
 d 55-56 = 8,16 m
 d 56-57 = 12,87 m
 d 57-58 = 33,34 m
 d 58-59 = 2,23 m
 d 59-60 = 0,59 m
 d 60-61 = 17,82 m
 d 61-62 = 10,40 m
 d 62-63 = 10,05 m
 d 63-64 = 17,18 m
 d 64-65 = 16,15 m
 d 65-66 = 25,29 m

392900

684300

392600

684000

684100

684200

684300

206

205

204

201

202

203

199

198

196

197

195

193

192

191

189

188

187

186

185

184

38

39

40

41

42

43

44

45

49

50

51

52

53

54

55

56

57

60

59

58

61

62

63

64

65

66

parc

parcare auto

Strada

Str. Hortensiei

Incir
Cate
grecc
"St
n

d 102-103 = 6,69 m
 d 103-104 = 6,24 m
 d 104-105 = 4,52 m
 d 105-106 = 4,52 m
 d 106-107 = 4,70 m
 d 107-108 = 8,61 m
 d 108-109 = 10,87 m
 d 109-110 = 5,95 m
 d 110-111 = 16,50 m
 d 111-112 = 9,12 m
 d 112-113 = 20,19 m
 d 113-114 = 13,32 m
 d 114-115 = 8,26 m
 d 115-116 = 20,41 m
 d 116-117 = 12,66 m
 d 117-118 = 1,08 m
 d 118-119 = 21,59 m
 d 119-120 = 2,32 m

d 175-176 = 32,71 m
 d 176-177 = 4,66 m
 d 177-178 = 222,23 m
 d 178-179 = 6,85 m
 d 179-180 = 132,12 m
 d 180-181 = 34,43 m
 d 181-182 = 36,88 m
 d 182-183 = 5,04 m
 d 183-184 = 42,14 m
 d 184-185 = 3,82 m
 d 185-186 = 7,73 m
 d 186-187 = 22,84 m
 d 187-188 = 19,31 m
 d 188-189 = 23,15 m
 d 189-190 = 4,44 m
 d 190-191 = 20,31 m

d 95-96 = 5,78 m
 d 96-97 = 3,00 m
 d 97-98 = 3,63 m
 d 98-99 = 4,24 m
 d 99-100 = 4,22 m
 d 100-101 = 8,46 m
 d 101-102 = 9,61 m

d 84-85 = 3,03 m
 d 85-86 = 3,04 m
 d 86-87 = 2,92 m
 d 87-88 = 6,10 m
 d 88-89 = 5,95 m
 d 89-90 = 6,01 m
 d 90-91 = 6,03 m
 d 91-92 = 42,83 m
 d 92-93 = 6,71 m
 d 93-94 = 5,65 m
 d 94-95 = 3,64 m

d 75-76 = 14,64 m
 d 76-77 = 23,91 m
 d 77-78 = 21,06 m
 d 78-79 = 12,09 m
 d 79-80 = 5,54 m
 d 80-81 = 21,01 m
 d 81-82 = 21,05 m
 d 82-83 = 3,06 m
 d 83-84 = 3,08 m

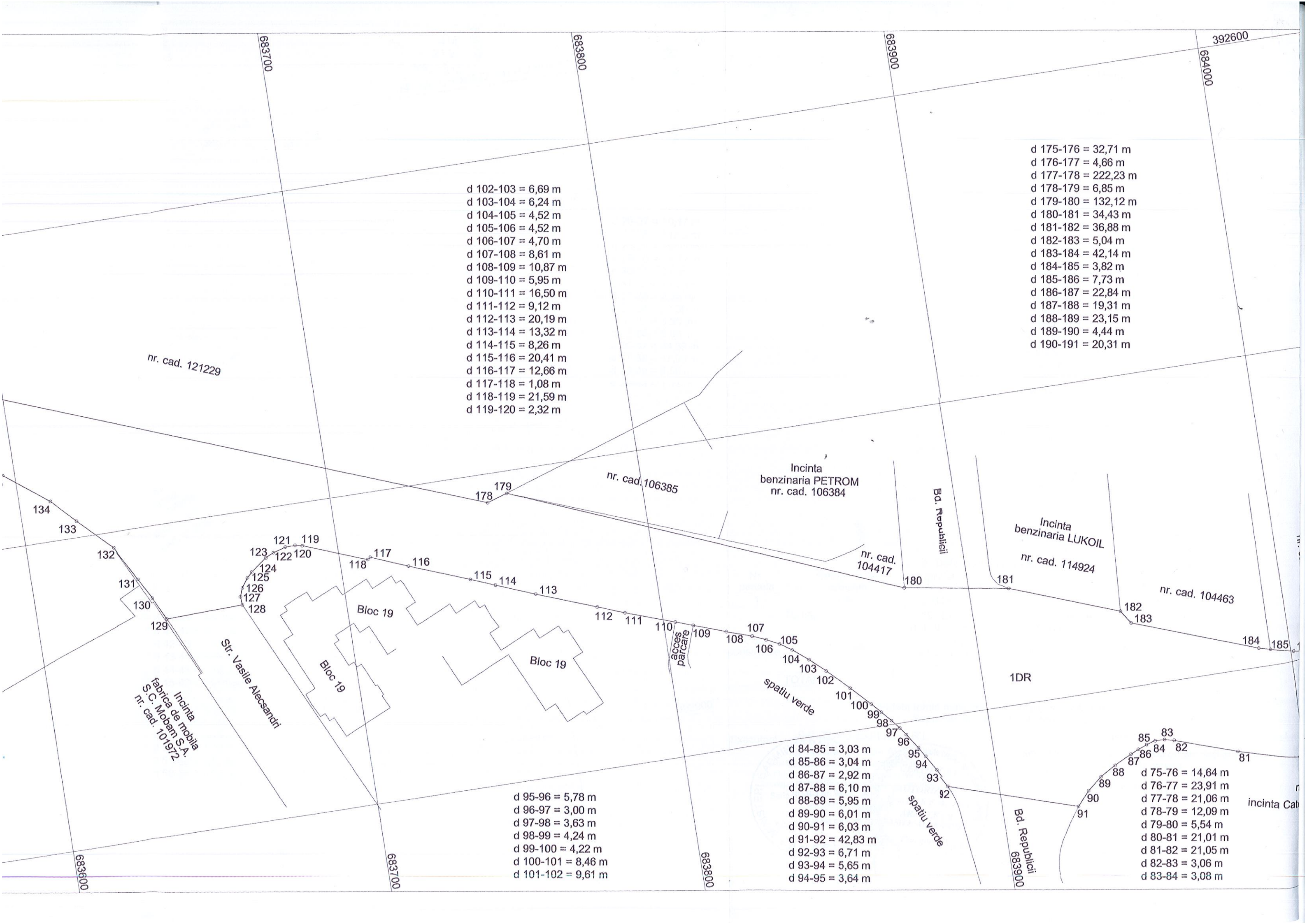

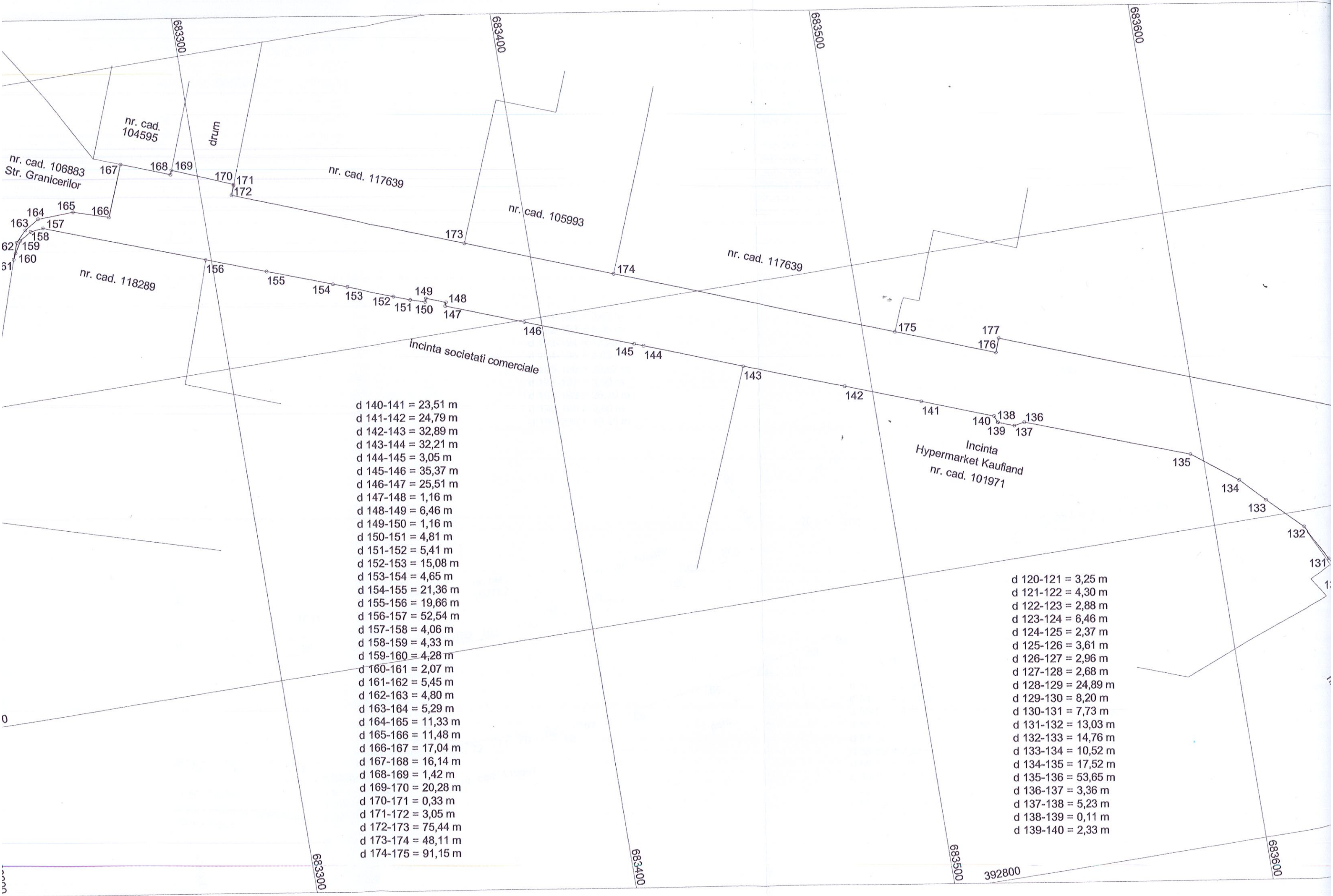

nr. cad. 104595

nr. cad. 106883
Str. Granicerilor

nr. cad. 117639

nr. cad. 105993

nr. cad. 117639

nr. cad. 118289

Incinta societati comerciale

Incinta
Hypermarket Kaufland
nr. cad. 101971

- d 140-141 = 23,51 m
- d 141-142 = 24,79 m
- d 142-143 = 32,89 m
- d 143-144 = 32,21 m
- d 144-145 = 3,05 m
- d 145-146 = 35,37 m
- d 146-147 = 25,51 m
- d 147-148 = 1,16 m
- d 148-149 = 6,46 m
- d 149-150 = 1,16 m
- d 150-151 = 4,81 m
- d 151-152 = 5,41 m
- d 152-153 = 15,08 m
- d 153-154 = 4,65 m
- d 154-155 = 21,36 m
- d 155-156 = 19,66 m
- d 156-157 = 52,54 m
- d 157-158 = 4,06 m
- d 158-159 = 4,33 m
- d 159-160 = 4,28 m
- d 160-161 = 2,07 m
- d 161-162 = 5,45 m
- d 162-163 = 4,80 m
- d 163-164 = 5,29 m
- d 164-165 = 11,33 m
- d 165-166 = 11,48 m
- d 166-167 = 17,04 m
- d 167-168 = 16,14 m
- d 168-169 = 1,42 m
- d 169-170 = 20,28 m
- d 170-171 = 0,33 m
- d 171-172 = 3,05 m
- d 172-173 = 75,44 m
- d 173-174 = 48,11 m
- d 174-175 = 91,15 m

- d 120-121 = 3,25 m
- d 121-122 = 4,30 m
- d 122-123 = 2,88 m
- d 123-124 = 6,46 m
- d 124-125 = 2,37 m
- d 125-126 = 3,61 m
- d 126-127 = 2,96 m
- d 127-128 = 2,68 m
- d 128-129 = 24,89 m
- d 129-130 = 8,20 m
- d 130-131 = 7,73 m
- d 131-132 = 13,03 m
- d 132-133 = 14,76 m
- d 133-134 = 10,52 m
- d 134-135 = 17,52 m
- d 135-136 = 53,65 m
- d 136-137 = 3,36 m
- d 137-138 = 5,23 m
- d 138-139 = 0,11 m
- d 139-140 = 2,33 m

683300

683400

683500

392800

683600